

## SMART STOP™

WELKER SMART STOP™ DOES ALL STOPPING & SENSING FUNCTIONS IN ONE PART.  
MINIMIZES ENGINEERING, FIELD SET UP AND OPERATOR ADJUSTMENT TIME.

### ELIMINATES:

- ∅ NEED FOR SEPARATE MOUNTS, BRACKETS & FLAGS.
- ∅ NEED FOR SWITCH ADJUSTMENTS WHEN SHIMMING.
- ∅ IMPROPER ADJUSTMENT OF OUTBOARD SWITCHES.
- ∅ OUTBOARD SWITCH VIBRATING LOOSE IN BRACKET.
- ∅ PROTECTING OUTBOARD PROXES FROM BEING STEPPED ON OR BENT IN TOOLS.

### NAAMS INTERCHANGEABLE

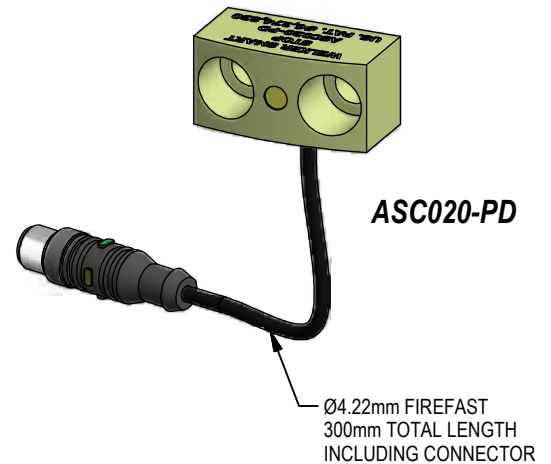

### ASC021-PD

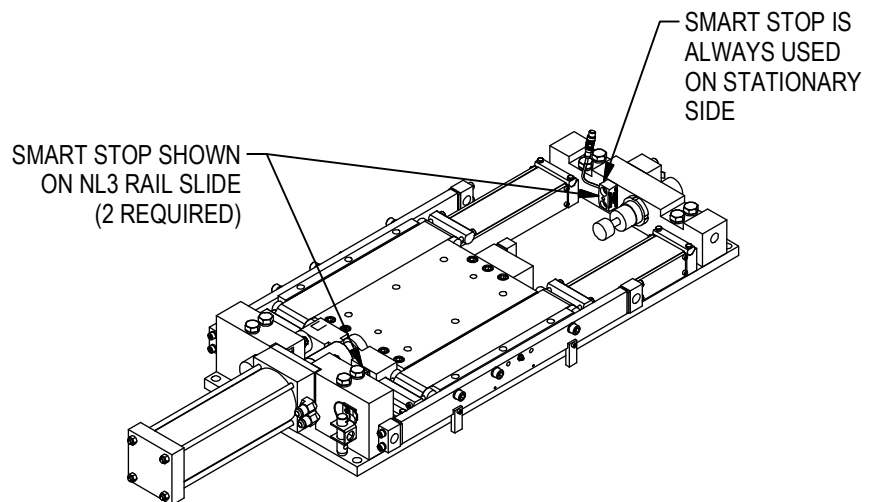
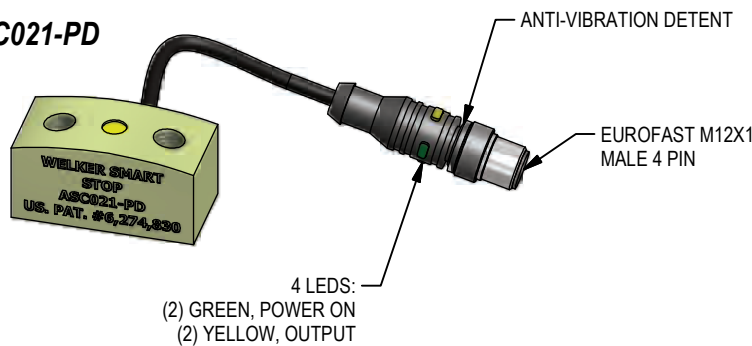

RELEASED 4/9/18

# ORDERING INFORMATION: 25mm TALL SERIES USING M10 FASTENERS

ORDER AS OPTION "P" ON THESE WELKER SLIDES:

- P5, P7 Plane Bearing Slides
- H7 Plane Bearing Slide
- R2 Rolling Element Slide
- NL3 Narrow Low Profile Rail Slide
- WL3 Wide Low Profile Rail Slide
- LP1, LP2 Compact Rail Slides
- DB4 Guided Slide

TO ORDER SEPARATELY OR AS REPLACEMENT PART USE PART NUMBERS BELOW:

## DIMENSIONS

(CABLE & CONNECTOR NOT SHOWN FOR CLARITY)

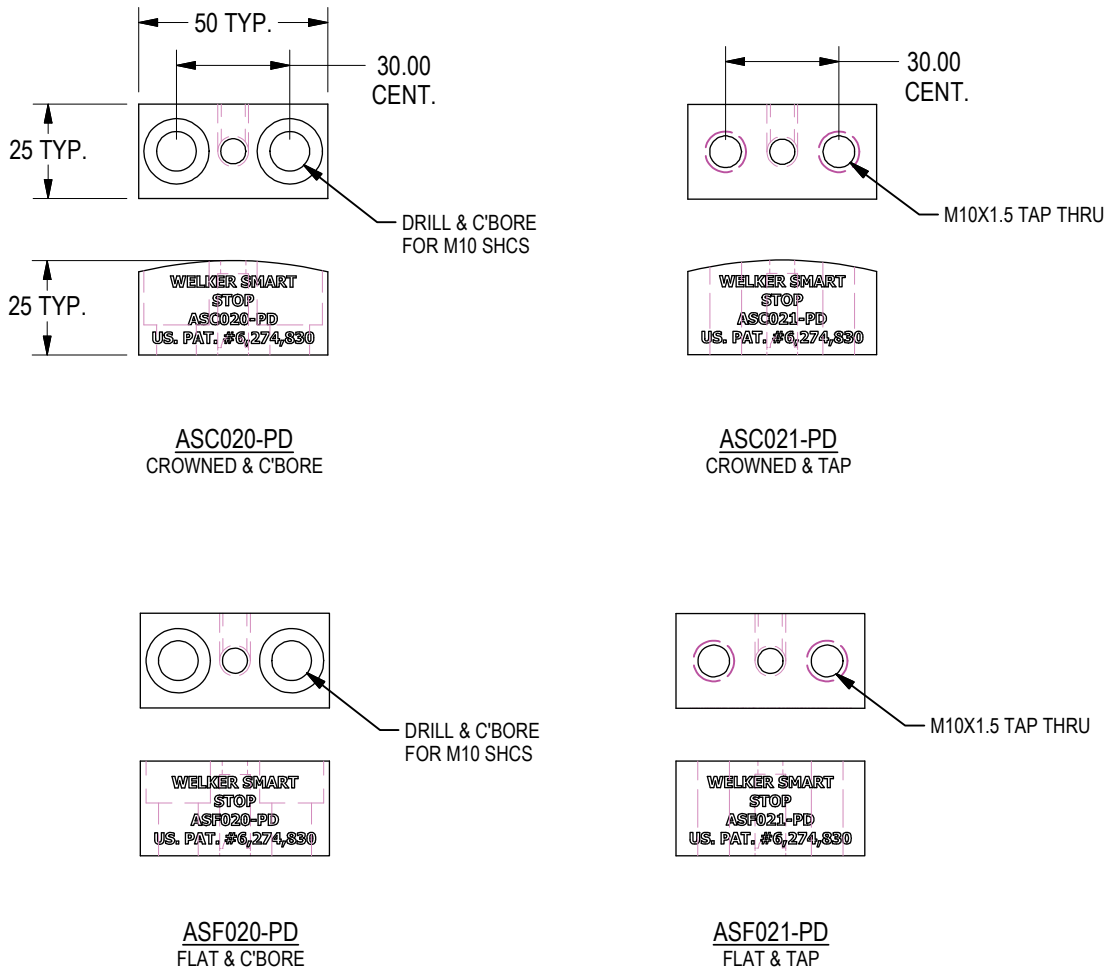

(DO NOT SCALE DRAWING)



# ORDERING INFORMATION: 20mm TALL SERIES USING M8 FASTENERS

## DIMENSIONS

(CABLE & CONNECTOR NOT SHOWN FOR CLARITY)

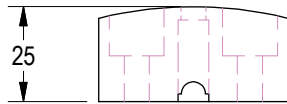
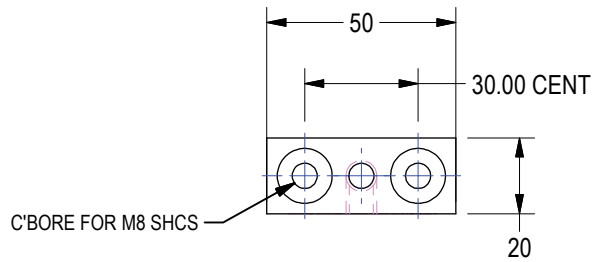

ASC018-PD  
CROWNED & C'BORE

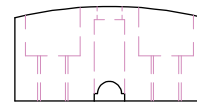
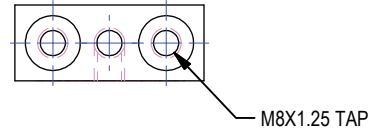

ASC019-PD  
CROWNED & TAP

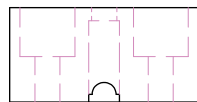
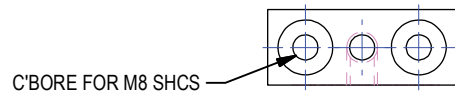

ASF018-PD  
FLAT & C'BORE

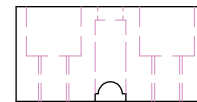
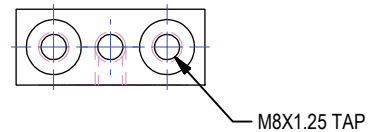

ASF019-PD  
FLAT & TAP



(DO NOT SCALE DRAWING)



## SMART STOP SWITCH: GENERAL SPECIFICATIONS

CONTACT CARRIER MATERIAL	PUR
MOLDED HEAD MATERIAL/COLOR (RSE)	THERMOPLASTIC PUR/BLACK
CONTACT MATERIAL/PLATING (RSE)	GOLD-PLATED BRASS
COUPLING NUT MATERIAL/PLATING (RSE)	NICKEL-PLATED BRASS
RATED OPERATING DISTANCE	2mm = .079" (NOMINAL) APPROX +0.5mm -1.0mm
MOUNTING MODE	FLUSH
HYSTERESIS (DIFFERENTIAL TRAVEL)	3-15%
MAX. RELATIVE TEMPERATURE DRIFT	LESS THAN OR EQUAL TO $\pm 10\%$
MIN. REPEAT ACCURACY	LESS THAN OR EQUAL TO 2%
OPERATING TEMPERATURE	-25 TO 70° (-13 TO 158° F)
RATED OPERATIONAL VOLTAGE (DC)	10-30 VDC
MAX. RIPPLE	LESS THAN OR EQUAL TO 10%
RATED OPERATIONAL CURRENT	LESS THAN OR EQUAL TO 150 mA
NO-LOAD CURRENT	LESS THAN OR EQUAL TO 15mA
MAX. OFF-STATE CURRENT	LESS THAN OR EQUAL TO 0.1mA
MAX SWITCHING FREQUENCY	LESS THAN OR EQUAL TO 2kHz
RATED INSULATION VOLTAGE	0.5 kV
OUTPUT FUNCTION	3-WIRE, NORMALLY OPEN, PNP
SHORT-CIRCUIT PROTECTION	YES
MAX. VOLTAGE DROP	LESS THAN OR EQUAL TO 1.8 V
WIRE BREAKAGE/REVERSE POLARITY PROTECT	YES
DEGREE OF PROTECTION	IP 67
HOUSING MATERIAL	SST, V2A 1.4301
ACTIVE FACE	PLASTIC, PA12-GF30
OUTER CABLE JACKET (SENSOR)	3mm PUR
VIBRATION RESISTANCE	55 Hx (1mm)
SHOCK RESISTANCE	30 x g (11 ms)
PIGTAIL LED COLOR	GREEN=POWER, YELLOW=OUTPUT

*SMART STOP IS USED TO SENSE FULL STOP AGAINST BLOCK (ONLY)*

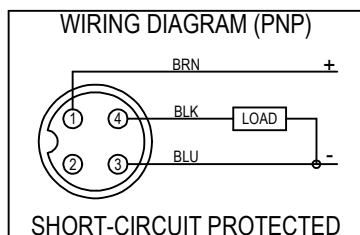

(DO NOT SCALE DRAWING)

**WELKER**  
ENGINEERED PRODUCTS  
800-229-0890 [www.welkerproducts.com](http://www.welkerproducts.com)

# SMART STOP™ PANCAKE SWITCHES

ALL PANCAKE SWITCH BLOCKS USE THESE FASTENERS:  
M8 IN C'BORES M10 IN TAPS

## ORDERING INFORMATION

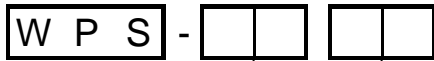

### Block

- 01 Wide Flat
- 02 Wide Crown
- 03 Wide Target
- 04 Narrow Flat
- 05 Narrow Crown
- 06 Narrow Target

### Switch

- 00 No Switch  
(Default for blocks 03 & 06)
- 01 Turck ~ BI 5U-Q08-AP6X2-0.2M-RS 4T/S1589 (3-Wire, 4-Pin)
- 02 Balluff ~ BES R01ZC-PSC50B-BZ00,2-GS04-W05 (3-Wire, 4-Pin)
- 03 Peppri + Fuchs ~ NMB6-F104M-E2-C-FE-200MM-V1 (3-Wire, 3-Pin)  
Metal faced, weld immune

All Switches are DC M12 X 1 (PNP) Connector

## WIDE SERIES PANCAKE SWITCHES\*

WIDE SERIES SWITCHES CAN BE FIELD REVERSED TO HAVE THE CORD EXTEND THE OPPOSITE DIRECTION

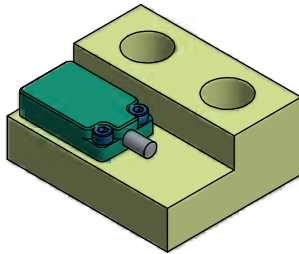

BLOCK 01  
WIDE FLAT

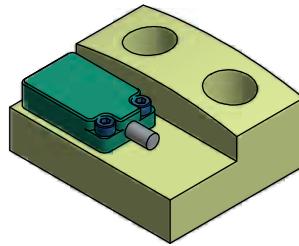

BLOCK 02  
WIDE CROWN

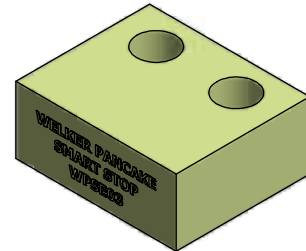

BLOCK 03  
WIDE TARGET

## NARROW SERIES PANCAKE SWITCHES\*

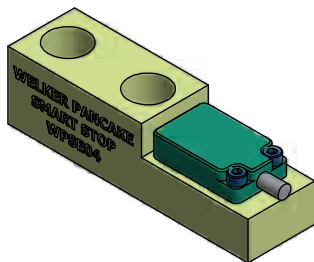

BLOCK 04  
NARROW FLAT

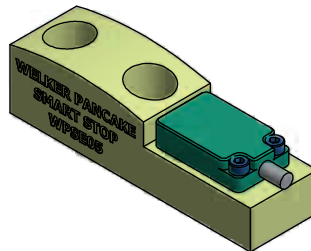

BLOCK 05  
NARROW CROWN

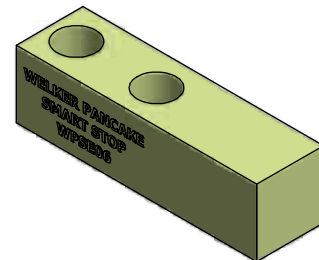

BLOCK 06  
NARROW TARGET



\*BLOCK DIMENSIONS ARE ON FOLLOWING PAGES

(DO NOT SCALE DRAWING)



# WIDE SERIES BLOCK DIMENSIONS

**BLOCK 01  
WIDE FLAT**

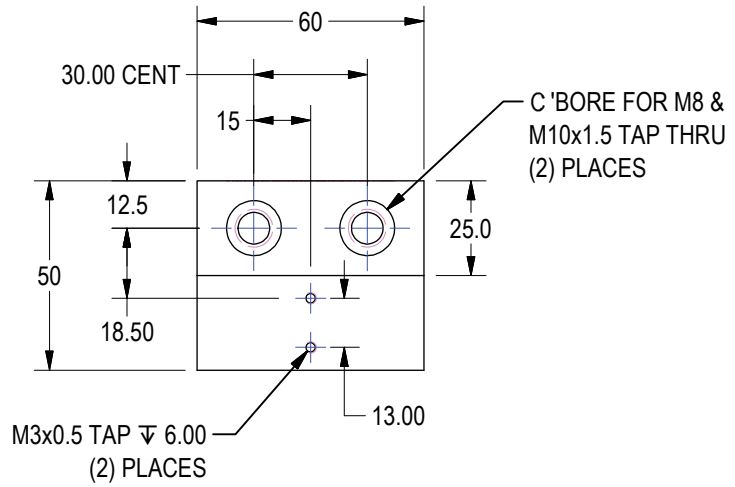
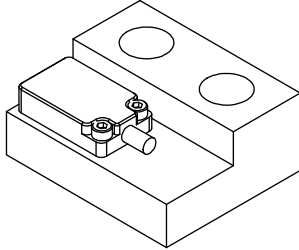

**BLOCK 02  
WIDE CROWN**

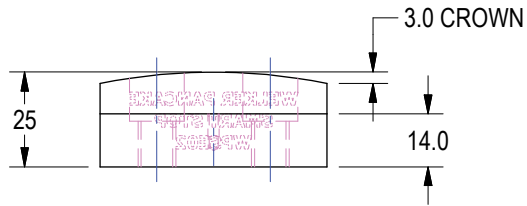
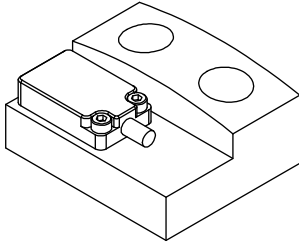

**BLOCK 03  
WIDE TARGET**

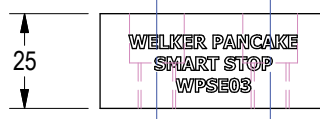
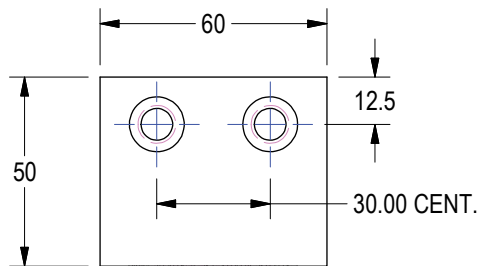
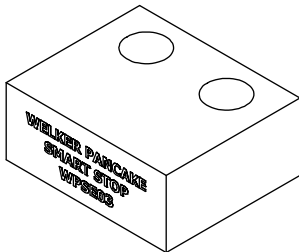

(DO NOT SCALE DRAWING)



# NARROW SERIES BLOCK DIMENSIONS

**BLOCK 04  
NARROW FLAT**

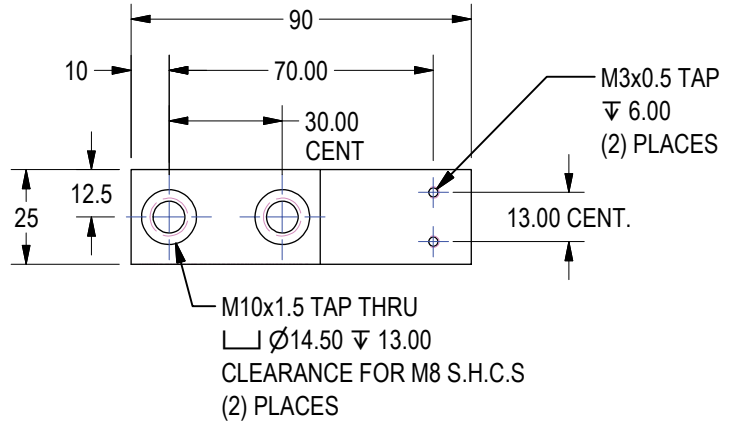
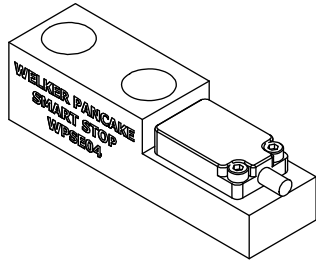

**BLOCK 05  
NARROW CROWN**

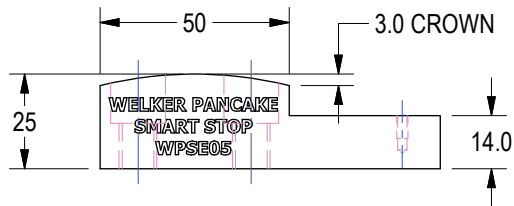
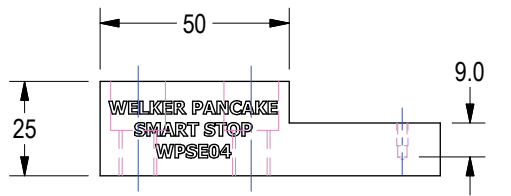
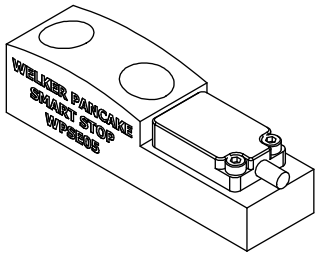

**BLOCK 06  
NARROW TARGET**

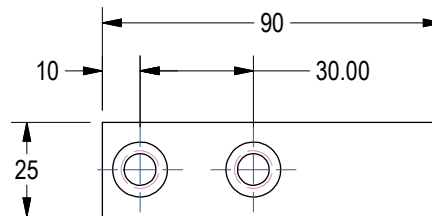
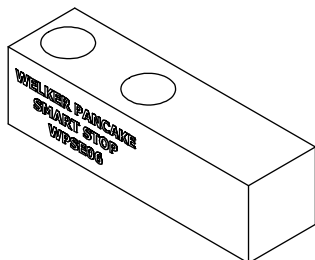

(DO NOT SCALE DRAWING)

