

## ELECTRIC SLIDE STYLES

### RAIL SLIDES

GUIDED LINEAR MOTION PROVIDED BY ROLLING ELEMENT BEARINGS ALONG RAILS

#### STANDARD RAIL SLIDES

R2 SERIES

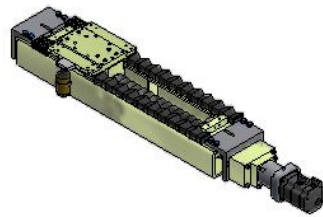

#### HEAVY DUTY RAIL SLIDES

TOOL TRAY SHUTTLES, VOSS

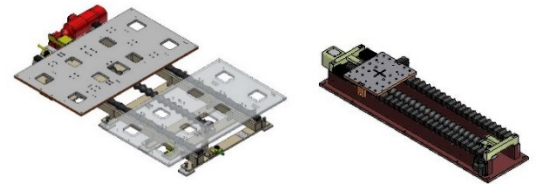

#### LOW PROFILE RAIL SLIDES

NARROW LOW PROFILE NL3 SERIES

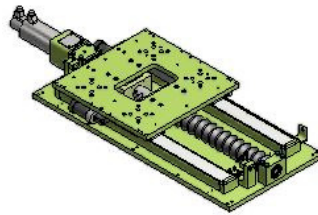

WIDE LOW PROFILE WL3 SERIES

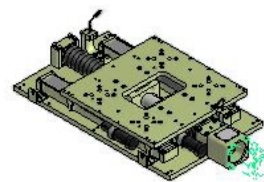

### EXTRUSION FRAME RAIL SLIDES

DUAL AXIS

SINGLE OR DOUBLE RAIL/MOTOR

#### PUSHER OR PULLER SLIDES

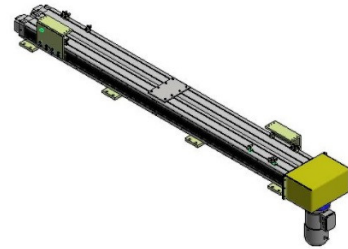
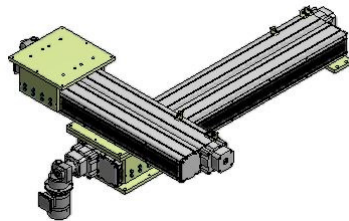
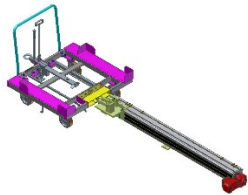

### PLANE BEARING SLIDES

GUIDED LINEAR MOTION PROVIDED BY PTFE COMPOSITE BEARINGS ALONG CHROME SHAFTS

P5, P7 & H7 SERIES

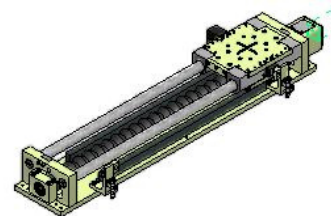
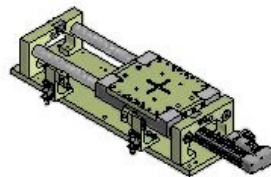

## GENERAL SPECIFICATIONS

SLIDE STYLE (see page 3)	MAX LOAD	MAX LENGTH	MAX LOAD SIZE, CENTERED
Standard Rail: R2	2000 lbf	500mm	
Low Profile Rail: NL3/WL3	4000 lbf	480mm	
Heavy Duty Rail: VOSS	4000 lbf	500mm	
Tool Tray Shuttle: Heavy Duty Rail	TBD	Screw: 5100mm/Belt: TBD	
Single Extrusion Frame Rail	500 lbf	5100mm	36"W x 48"L
Double Extrusion Frame Rail	1000 lbf	Screw: 5100mm/Belt: TBD	60"W x 60"L
Plane Bearing: P5/P7/H7	800 lbf	500mm	

## ELECTRIC ACTUATORS

ACTUATOR TYPE	FEATURES & BENEFITS	APPLICATIONS
VFD (Variable Frequency Drive) Welker standard AC induction motor and gearbox is Nord brand, right angle gearbox with brake.	Cost savings; least expensive when used with <1HP (800 watt) applications. Lowest cost in low speed applications. Easy to change decel and stop points by moving switches. Space saving right-angle configurations. Repeatability +/- 1mm	Part presentation Elevators Cart pullers
Servo Welker standard is Exlar Tritex II integrated servo with Ethernet Absolute encoder and brake.	High speed capacities. High load capacities. Extreme accuracy. Repeatability +/- .005 rolled ball screw Repeatability +/- .001 ground ball screw Multiple positions; cycle resumes after e-stop	Clinch or weld gun positioning Geo model select Tool tray actuator

All robot motors and controllers are supplied by customer (Kuka, Fanuc, Nachi, ABB, Kawasaki, etc.)  
Welker will provide motor math and an engineering drawing of the slide in PDF format based on the information submitted with the Electric Slide Worksheet. The PDF must be approved and signed before an order can be accepted.  
Welker will supply ONLY what is shown on the signed PDF.

## STANDARD SCREW DRIVES

TYPE	MAX SPEED
Lead screw 1-7/16 x 3	18 inches per second
Lead screw 1-7/8 x 4	24 inches per second
Ball screw 1-1/2 x 1	Depends on length
Ball screw 40 x 40	Depends on length

Other screws available per application