

SERVO SHIM POSITIONER

MAXIMIZES TOOLING FLEXIBILITY BY ALLOWING QUICK REPOSITIONING OF COMPONENTS FOR BUILD TREND CHANGE.

DUAL AXIS

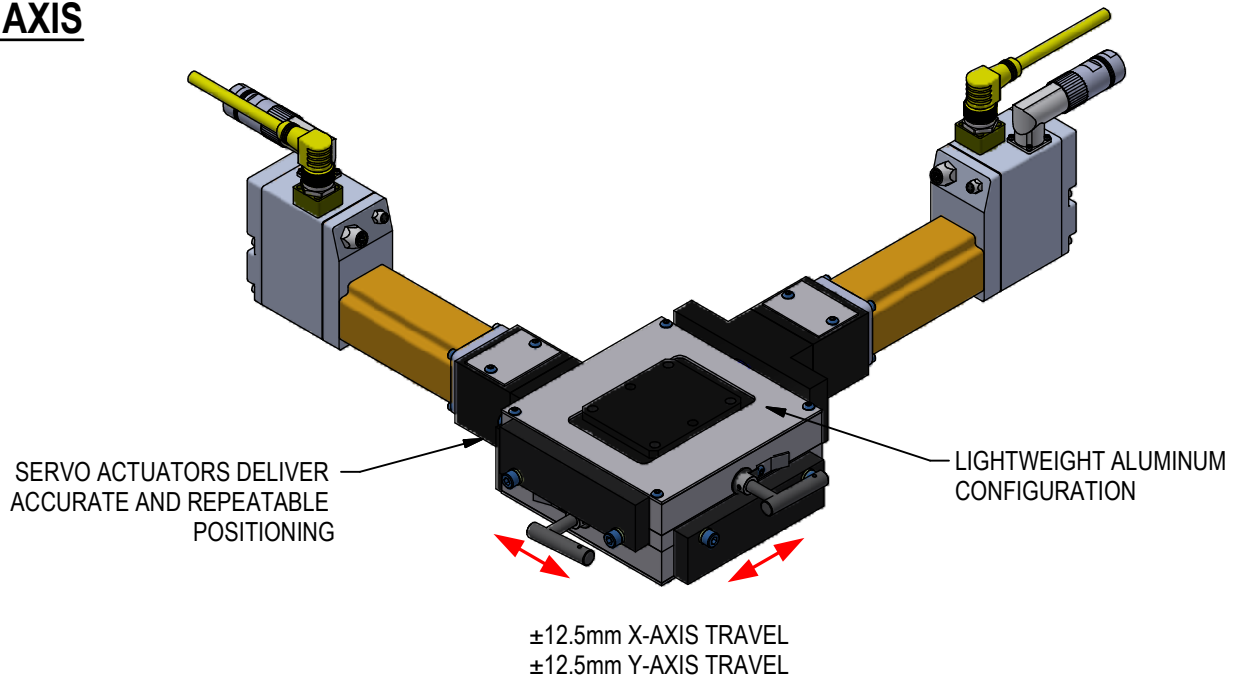

SINGLE AXIS

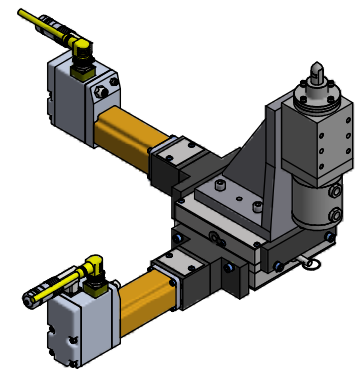
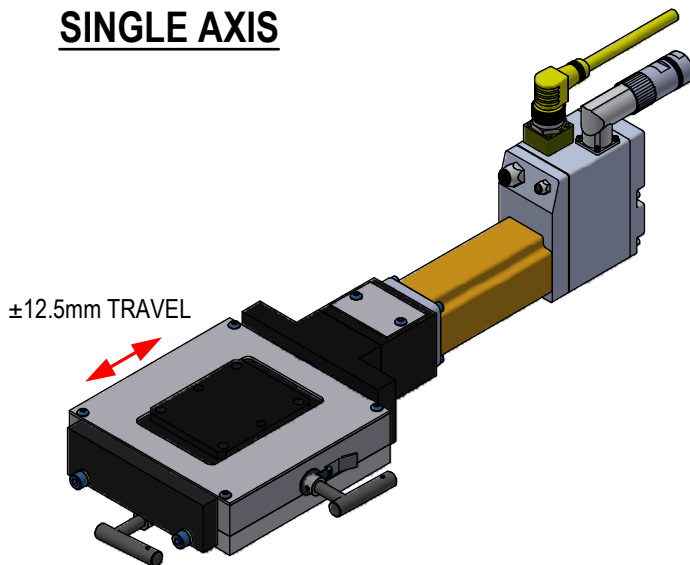

TYPICAL APPLICATION

SHOWN WITH WELKER PIN CLAMP AS LOCATOR & CLAMP, REPOSITIONS QUICKLY FOR BUILD TREND CHANGE

RELEASED 3/8/23

ORDERING INFORMATION

NOTE: ALL BOXES MUST BE FILLED IN FOR A COMPLETE PART NUMBER

S	0	1	4	7	4	-					
---	---	---	---	---	---	---	--	--	--	--	--

Series

S01474

Axis Option

- SX** Single Axis
- DR** Double Axis - Right
- DL** Double Axis - Left

Connector Pos. Motor A

- A1** Motor "A" Connector Position (See Sheet 5)

Connector Pos. Motor B

- X0** For Single Axis Only
- B1** Motor "B" Connector Position (See Sheet 5)

MOTOR INFO:

EXLAR TRITEX II DC GEARMOTOR, 24/48 VDC
5:1 GEAR REDUCTION
ABSOLUTE FEEDBACK
ETHERNET IP (SEALED M12 CONNECTOR)
UP TO 16 PROGRAMMED POSITIONS
ALL PROGRAMING TO BE DONE BY CUSTOMER

MOTOR PIN CONFIGURATION:

PIN 1 = 24 VDC BUS POWER
PIN 2 = 24 VDC LOGIC POWER PLUS
PIN 3 = GROUND
PIN 4 = 24 VDC COMMON POWER AND LOGIC

SLIDE INFO:

MAX LOAD: 150lbf
TRAVEL: 1 in/sec
5/8-10 ACME GROUND THREAD
SELF-LOCKING SCREW

WEIGHT INFO:

SINGLE: 21.1 lbs
DOUBLE: 38.4 lbs

(DO NOT SCALE DRAWING)



ENGINEERED PRODUCTS

800-229-0890 www.welkerproducts.com

GENERAL DIMENSIONS: SINGLE AXIS

ORDERING EXAMPLE (FOR MODEL SHOWN): S01474-SXA1X0

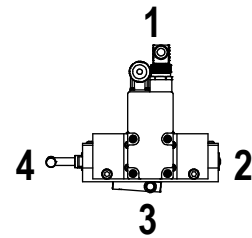
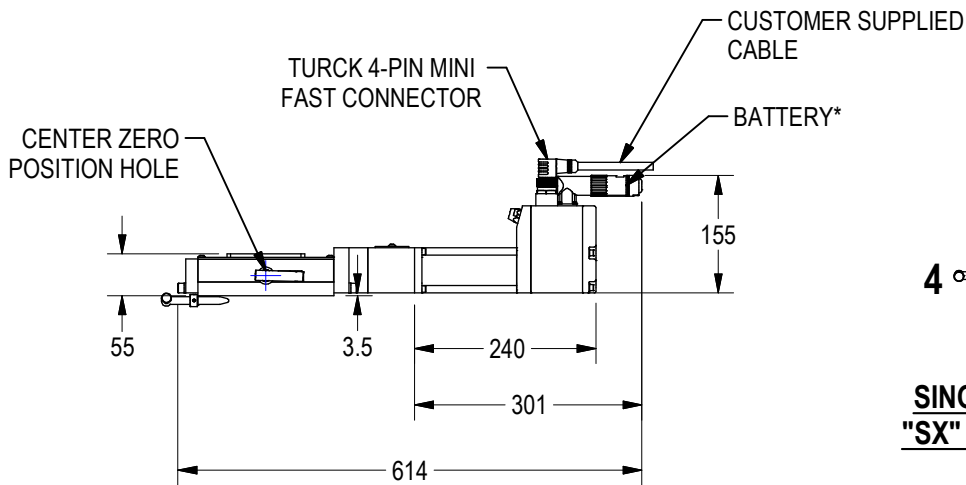
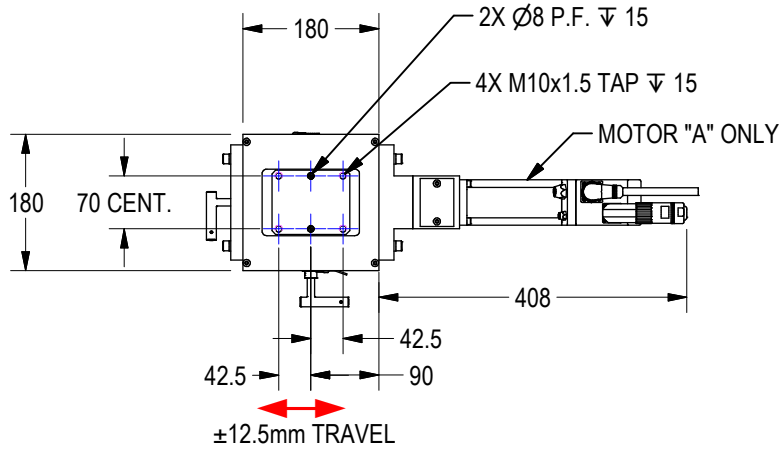

**SINGLE AXIS VERSION
"SX" MOTOR POSITIONS**

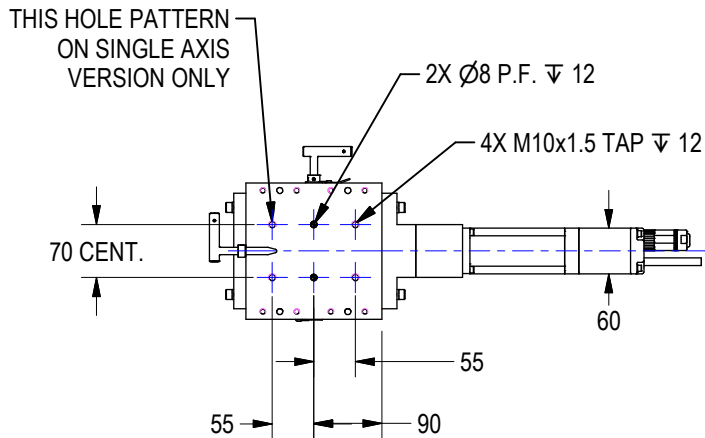

*BATTERY CAN PROVIDE POWER TO ENCODER FOR ABOUT 1.5 YEARS OF POWER-OFF TIME

(DO NOT SCALE DRAWING)

WELKER
ENGINEERED PRODUCTS
800-229-0890 www.welkerproducts.com

GENERAL DIMENSIONS: DOUBLE AXIS

ORDERING EXAMPLE (FOR MODEL SHOWN): S01474-DRA1B1

SEE SINGLE AXIS SHEET FOR DIMENSIONS NOT SHOWN

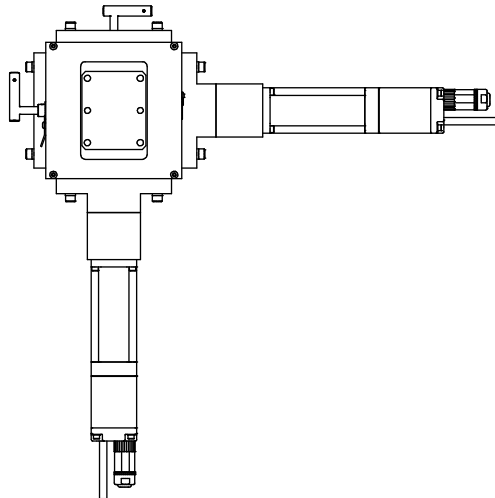
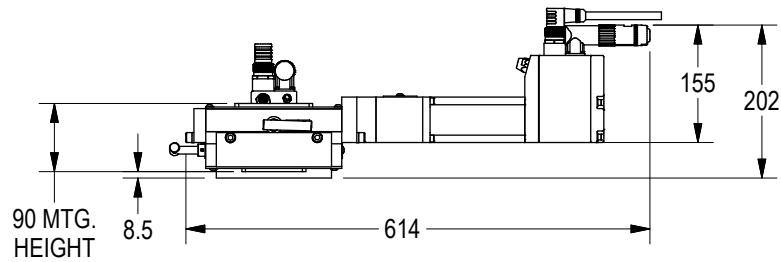
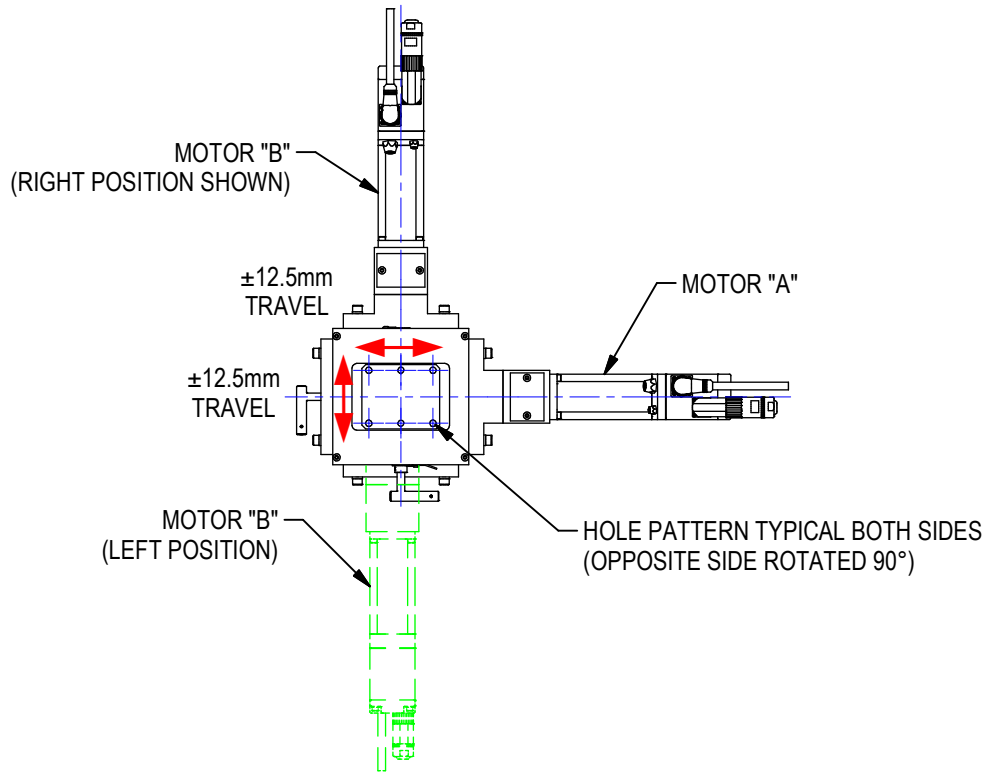

(DO NOT SCALE DRAWING)

WELKER
ENGINEERED PRODUCTS
800-229-0890 www.welkerproducts.com

MOTOR POSITIONS FOR DOUBLE AXIS VERSION

"DR" OPTION SHOWN

LEFT

RIGHT

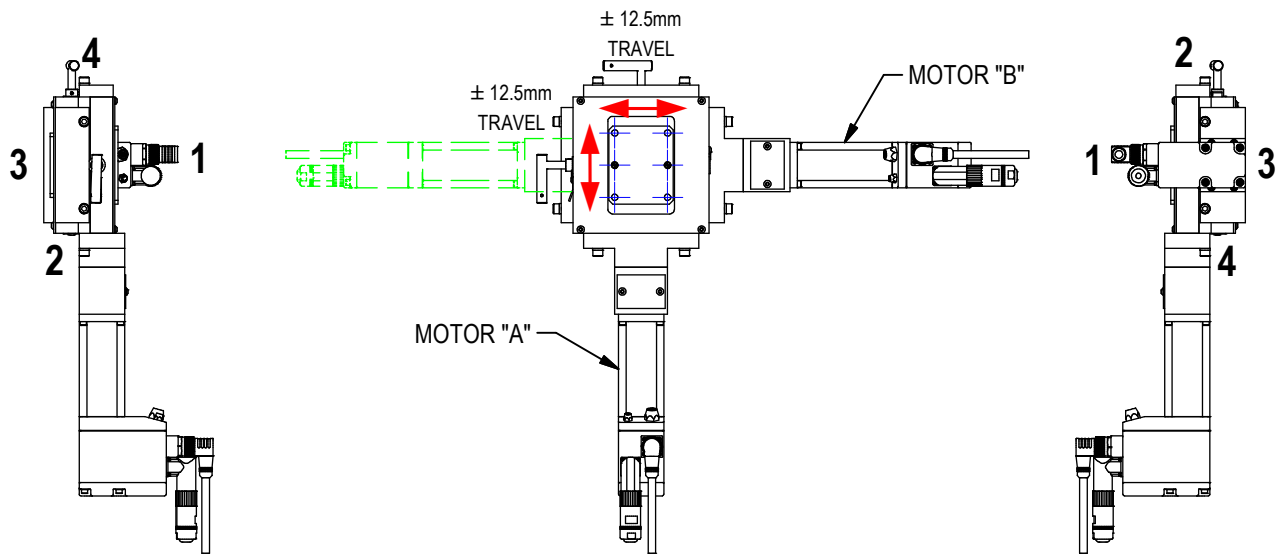

WORKING ENVELOPE

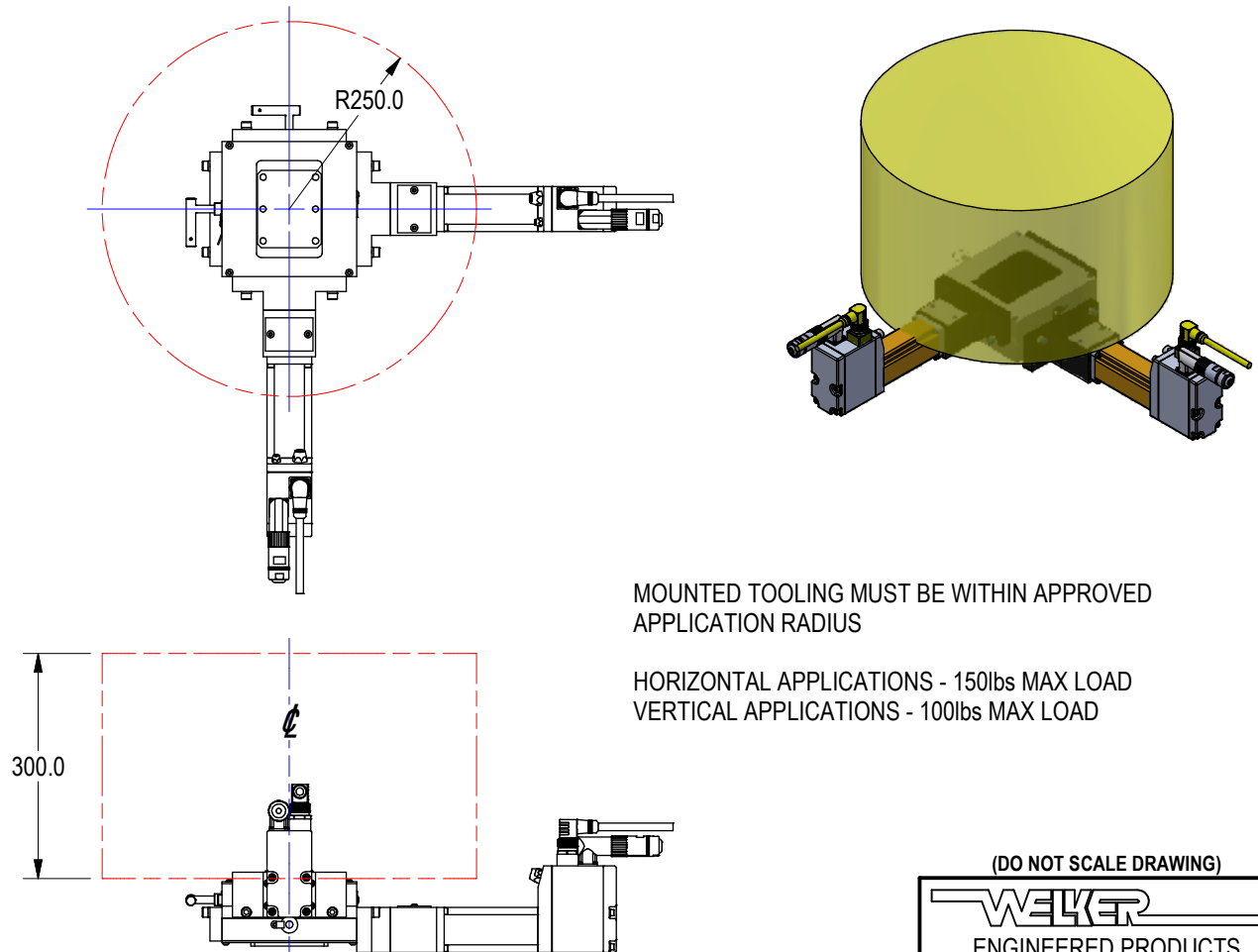

(DO NOT SCALE DRAWING)