

SMART STOP™

WELKER SMART STOP™ DOES ALL STOPPING & SENSING FUNCTIONS IN ONE PART.
MINIMIZES ENGINEERING, FIELD SET UP AND OPERATOR ADJUSTMENT TIME.

ELIMINATES:

- ∅ NEED FOR SEPARATE MOUNTS, BRACKETS & FLAGS.
- ∅ NEED FOR SWITCH ADJUSTMENTS WHEN SHIMMING.
- ∅ IMPROPER ADJUSTMENT OF OUTBOARD SWITCHES.
- ∅ OUTBOARD SWITCH VIBRATING LOOSE IN BRACKET.
- ∅ PROTECTING OUTBOARD PROXES FROM BEING STEPPED ON OR BENT IN TOOLS.

**NAAMS
INTERCHANGEABLE**

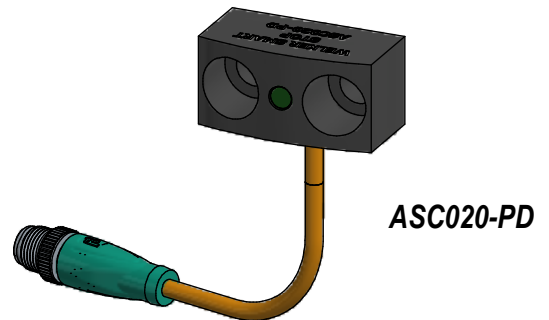

ASC021-PD

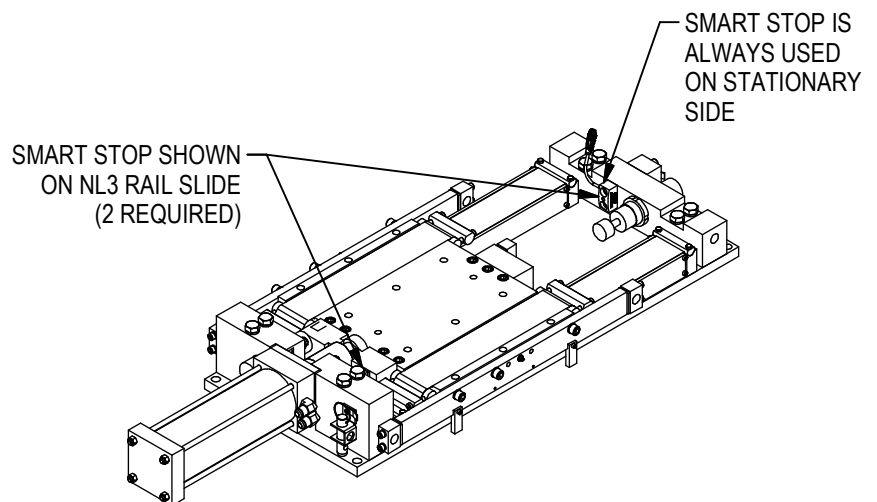
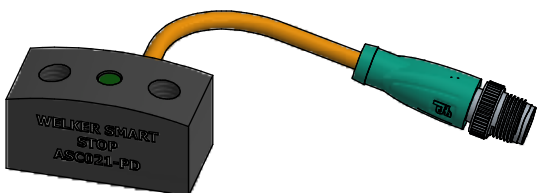

RELEASED 8/11/22

ORDERING INFORMATION: 25mm TALL SERIES USING M10 FASTENERS

ORDER AS OPTION "P" ON THESE WELKER SLIDES:

P5, P7 Plane Bearing Slides
H7 Plane Bearing Slide
R2 Rolling Element Slide
NL3 Narrow Low Profile Rail Slide
WL3 Wide Low Profile Rail Slide
LP1, LP2, LPM Compact Rail Slides
DB4 Guided Slide

TO ORDER SEPARATELY OR AS REPLACEMENT PART USE PART NUMBERS BELOW:

DIMENSIONS

(CABLE & CONNECTOR NOT SHOWN FOR CLARITY)

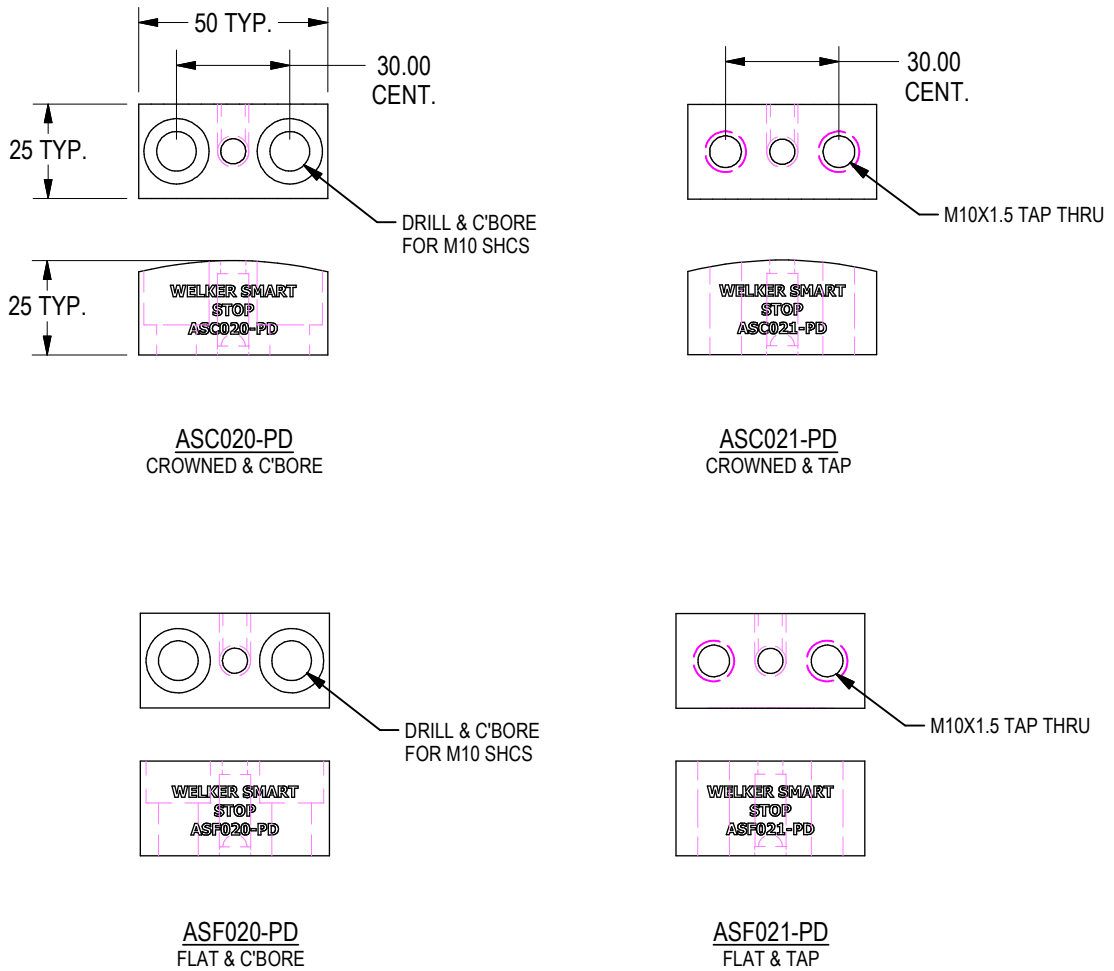

(DO NOT SCALE DRAWING)

WELKER
ENGINEERED PRODUCTS
800-229-0890 www.welkerproducts.com

ORDERING INFORMATION: 20mm TALL SERIES USING M8 FASTENERS

DIMENSIONS

(CABLE & CONNECTOR NOT SHOWN FOR CLARITY)

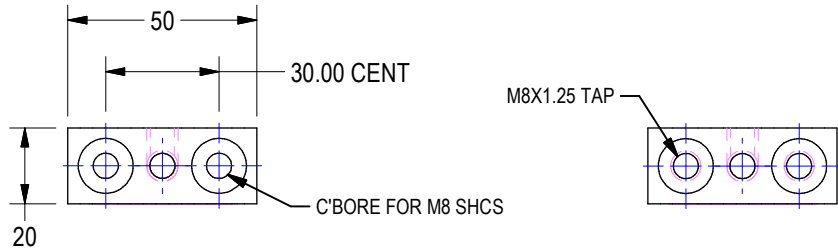

ASC018-PD
CROWNED & C'BORE

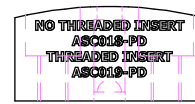

ASC019-PD
CROWNED & TAP

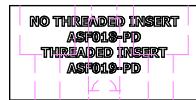
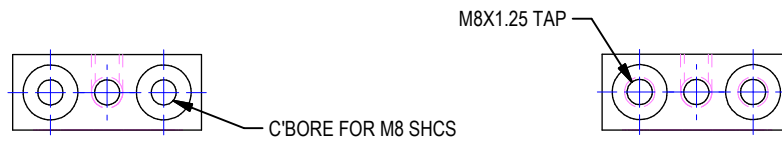

ASF018-PD
FLAT & C'BORE



ASF019-PD
FLAT & TAP



(DO NOT SCALE DRAWING)



SMART STOP SWITCH

General Specifications

Switching function	Normally Open (NO)
Output type	PNP
Rated operating distance, s_n	1.75mm
Output polarity	DC
Assured operating distance s_a	0 - 1.42 mm
Output type	3-wire

Nominal Ratings

Operating voltage, U_B	5 - 30 V DC
Switching frequency, f	0 - 6000 Hz
Reverse polarity protection	Reverse polarity protected
Short-circuit protection	Pulsing
Voltage drop, U_d	≤ 1.5 V
Operating current, I_L	0 - 100 mA
Off-state current, I_r	0 - 0.2 mA
No-load supply current, I_0	≤ 15 mA

Indicators/Operating Means

Operating voltage indicator	LED green
Switching state indicator	LED yellow

Ambient Conditions

Ambient temperature	-40 - 85 °C (-40 - 185 °F)
Storage temperature	-40 - 85 °C (-40 - 185 °F)

Mechanical Specifications

Connection type Connector plug	M12 x 1 , 4-pin
Cable length	255mm
Degree of protection	IP67
Cable material	Weld spatter resistant, robotic quality POC
Cable color	Orange

SMART STOP IS USED TO SENSE FULL STOP AGAINST BLOCK (ONLY)

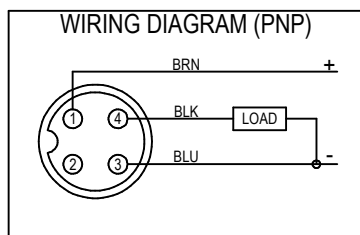

(DO NOT SCALE DRAWING)



SMART STOP™ PANCAKE SWITCHES

ALL PANCAKE SWITCH BLOCKS USE THESE FASTENERS:
M8 IN C'BORES M10 IN TAPS

ORDERING INFORMATION



Block

- 01 Wide Flat
- 02 Wide Crown
- 03 Wide Target
- 04 Narrow Flat
- 05 Narrow Crown
- 06 Narrow Target

Switch

- 00 No Switch
(Default for blocks 03 & 06)
- 01 Turck ~ BI 5U-Q08-AP6X2-0.2M-RS 4T/S1589 (3-Wire, 4-Pin)
- 02 Balluff ~ BES R01ZC-PSC50B-BZ00,2-GS04-W05 (3-Wire, 4-Pin)
- 03 Peppri + Fuchs ~ NMB6-F104M-E2-C-FE-200MM-V1 (3-Wire, 3-Pin)
Metal faced, weld immune

All Switches are DC M12 X 1 (PNP) Connector

WIDE SERIES PANCAKE SWITCHES*

WIDE SERIES SWITCHES CAN BE FIELD REVERSED TO HAVE THE CORD EXTEND THE OPPOSITE DIRECTION

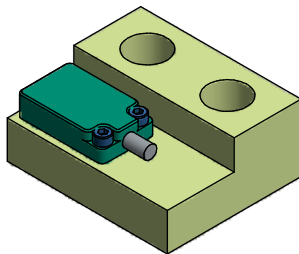

BLOCK 01
WIDE FLAT

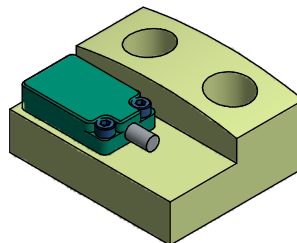

BLOCK 02
WIDE CROWN

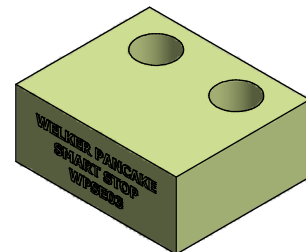

BLOCK 03
WIDE TARGET

NARROW SERIES PANCAKE SWITCHES*

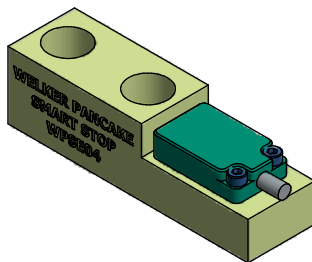

BLOCK 04
NARROW FLAT

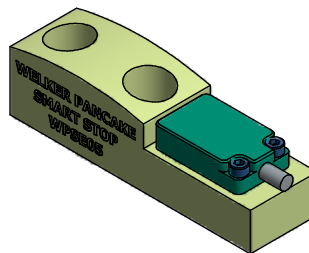

BLOCK 05
NARROW CROWN

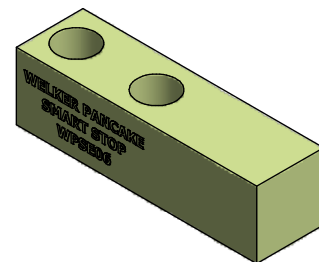

BLOCK 06
NARROW TARGET



*BLOCK DIMENSIONS ARE ON FOLLOWING PAGES

(DO NOT SCALE DRAWING)



WIDE SERIES BLOCK DIMENSIONS

**BLOCK 01
WIDE FLAT**

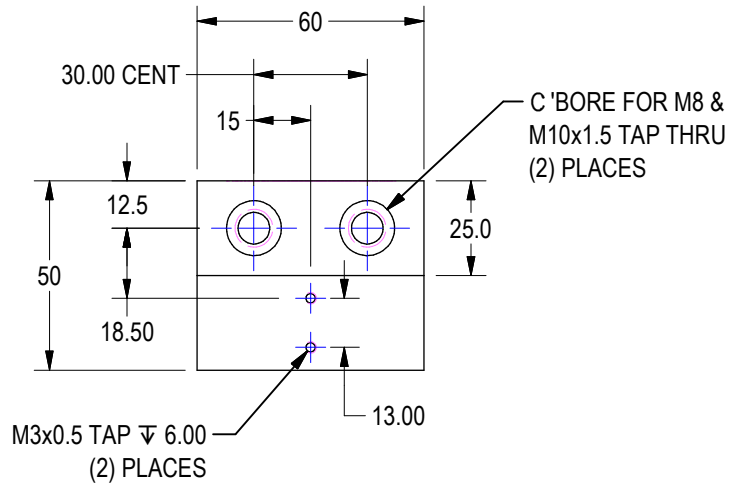
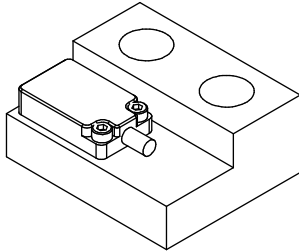

**BLOCK 02
WIDE CROWN**

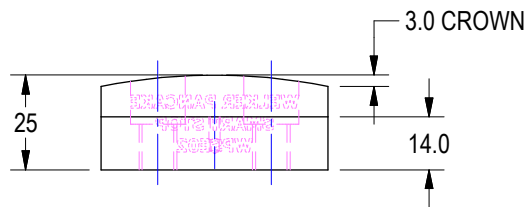
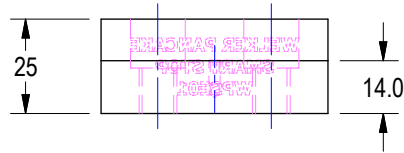
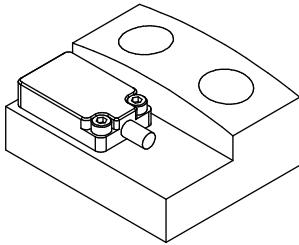

**BLOCK 03
WIDE TARGET**

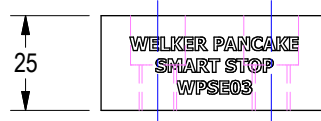
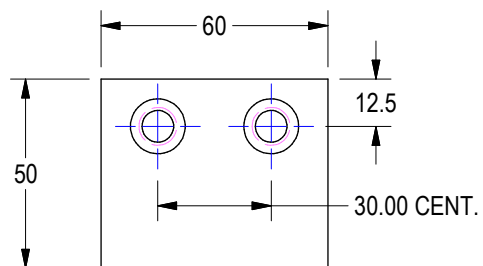
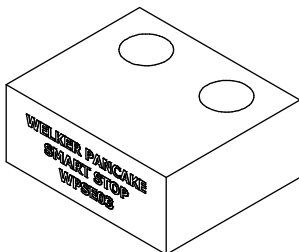

(DO NOT SCALE DRAWING)



NARROW SERIES BLOCK DIMENSIONS

**BLOCK 04
NARROW FLAT**

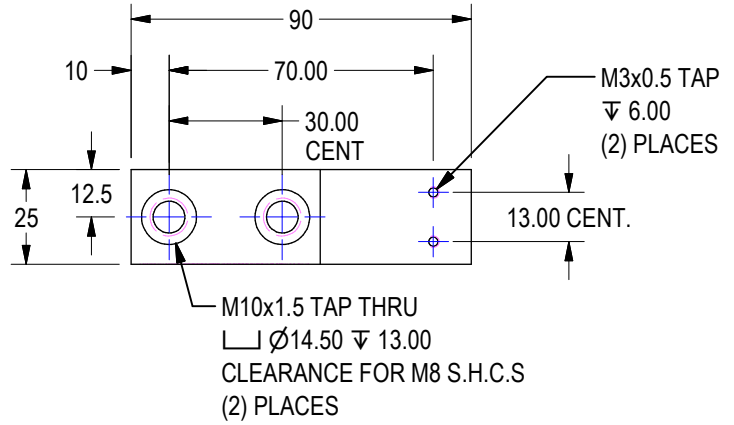
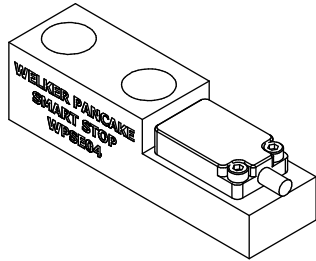

**BLOCK 05
NARROW CROWN**

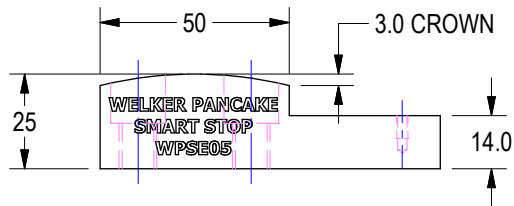
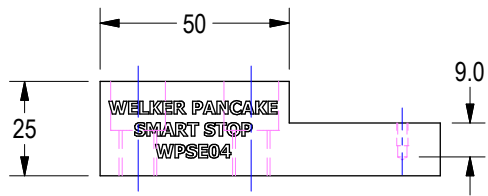
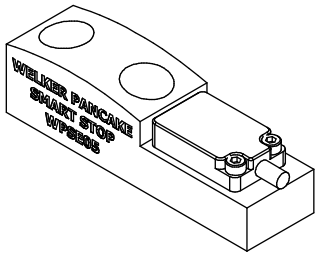

**BLOCK 06
NARROW TARGET**

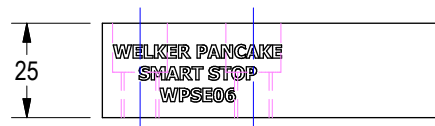
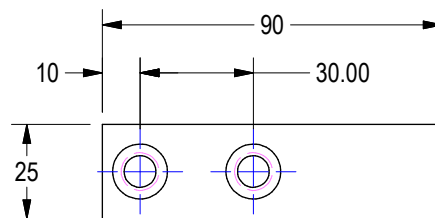
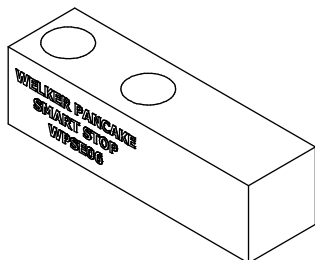

(DO NOT SCALE DRAWING)

